

## Wecryl Surface Protection System OS 8 high-build system

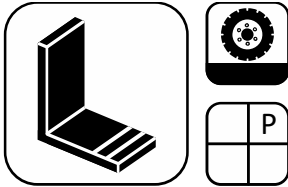

### Brief description

The Wecryl Surface Protection System OS 8 High-Build System is designed as rigid surfacing for areas that are subject to vehicular traffic as well as heavy mechanical and chemical wear and that are not at risk from cracking. It offers a wide range of design options with one or more colours and patterns. Its outstanding features also include its superior chemical resistance. The Wecryl Surface Protection System OS 8 High-Build System has been tested and certified in accordance with DAfStb (German Committee on Reinforced Concrete), the SIB 2001 directive (Protection and Repair of Concrete Elements), DIN V 18026 and EN 1504-2.

### Properties and advantages

- Abrasion-resistant and mechanically durable
- Resistant to chemicals and petrol resistant
- Permanently weather-resistant (resistant to high and low temperatures, UV rays, hydrolysis)
- Easy and fast application
- Reaction to fire classification B<sub>fl</sub>-s1 according to EN 13501-1
- Solvent-free
- Available in any RAL colour
- Fast-curing

### Applications

- Surface protection for areas in multi-storey car parks that are subject to pedestrian and vehicular traffic.
- Driving lanes and parking bays in internal decks and underground car parks that are and are not subject to weathering
- suitable for application on ramps

### Application conditions

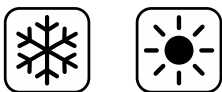

### Temperatures

The system can generally be applied within an ambient temperature range between +3 °C and +35 °C. Please refer to the table below for exact details.

Product	Temperature range, in °C		
	Air	Substrate*	Material
Primer layer			
Wecryl 176	+3 to +35	+3 to +50*	+3 to +30
Waterproofing of details			
Wecryl R 230 /-thix	-5 to +35	+3 to +50*	+3 to +30
Wearing layer			
Wecryl 418	-5 to +35	+3 to +35*	+3 to +30

\* The substrate temperature must be at least 3 °C above the dew point during application and curing.

### Moisture

The relative humidity must be ≤ 90 %.

The surface to be coated must be dry and ice-free.

The surface must be protected from moisture until the coating has hardened.

## Wecryl Surface Protection System OS 8 high-build system

### Consumption and reaction times

Product	Consumption [kg/m²]			
Primer layer	Substrate smooth	fine-sandy	coarse	
Wecryl 176	approx. 0.4	approx. 0.5	approx. 0.8	
Waterproofing of details	on top of the primer			
Wecryl R 230/-thix	3.00 kg/m²			
Wearing layer	on top of the primer			
Wecryl 418	approx. 3.50 kg/m²			
Product	Reaction time (approx. values at 20 °C)			
	Pot life	Rainproof	Overlayable	Curing time
Wecryl 176	10 min	30 min	30 min	2 hours
Wecryl R 230 /-thix	15 min	30 min	1 hour	3 hours
Wecryl 418	12 min	30 min	45 min	2 hours

### Application tools



Product	Application tool
Wecryl 176	Sheepskin roller
Wecryl R 230/-thix	Sheepskin roller
Wecryl 418	Aluminium blade approx. 60 cm or smoothing trowel

### Substrate preparation and primer selection

Correct substrate preparation and a flawless primer coating are essential for ensuring the functional durability of the WestWood System.

Generally, the substrate must be sound, dry, and free from loose and adhesion-reducing particles. That is why coats of paint, cement slurry, dirt and grease, for instance, must always be removed completely. As a rule, this is done by shot blasting, scarifying or grinding and then vacuuming off the debris.

The roughness height of the surface must then be determined using the sand surface method, and the values for additional layer thickness must be complied with (see DafStb guidelines (published 2001), "part 3, section 3.2.5 - Determination of roughness height" + table 5.2).

The primer coating then applied creates an ideal barrier and enables optimum adhesion between the substrate and the WestWood System. Please refer to the Application Guidelines - Substrate for the correct substrate preparation.

### Primer layer

The primer is applied to the prepared substrate.

Avoid small air bubbles (pin holes) can be closed or prevented by an application of substrate stabiliser Wecryl 821 to the entire area.

### Wecryl 176 – Primer for absorbent substrates

## Wecryl Surface Protection System OS 8 high-build system

Use the sheepskin roller to apply an even film-forming coat of primer. Avoid creating puddles of primer. Once the coating has cured, apply a second coat to cover any defects (bubbles, areas not fully coated).

### Levelling

Once the primer has hardened, use Wecryl 810, Wecryl 333 or Wecryl 842 to make good any areas of damage and/or height differences. Please refer to the application guidelines for the substrate.

Use Wecryl 885 Concrete Repair System for concrete repairs in structural applications (horizontal only).

### Waterproofing of details

#### **Wecryl R 230 /-thix**

Apply a generous and even layer of the mixed material to cover the entire area (at least 1.5 kg/m<sup>2</sup>), then immediately embed the WeVlies and use a sheepskin roller to remove any air bubbles. Immediately afterwards apply the remaining material (wet in wet, at least 1.0 kg/m<sup>2</sup>) up to the required total consumption rate (at least 3.0 kg/m<sup>2</sup>).

In each case a sheepskin roller is used to spread the material over the surface.

Fleece overlaps must be installed with at least 5 cm overlap.

Please refer to our drawings and computer animations for further information about waterproofing details (e.g. cutting the fleece to size).

### Wearing layer

#### **Wecryl 418 – Chemical-resistant textured flooring**

Spread the mixed material evenly using an aluminium blade or smoothing trowel and lay off to particle size thickness.

The advantage of using the aluminium blade is that this can minimise the otherwise normal trowel marks to create a smooth and even appearance.

### Design options

WestWood systems offer excellent scope for creative designs. Wecryl 418 can be used to create surfaces in one or more colours. The product also allows any pattern or markings to be incorporated.

### Cleaning the tools

If work is interrupted or when it is completed, clean the tools thoroughly with WestWood Cleaning Agent within the pot life of the material (approx. 12 minutes). This can be done with a brush.

The tools are ready to be used again as soon as the cleaning agent has evaporated fully.

Simply immersing the tools in the Cleaning Agent will not prevent the material from hardening.

### Information on safety and risks

Please refer to the safety data sheets for the products used.

### General information

The above information, especially information about application of the products, is based on extensive development work as well as many years of



Installation guideline

## Wecryl Surface Protection System OS 8 high-build system

experience and is provided to the best of our knowledge.

However, the wide variety of requirements and conditions on site mean that it is necessary for the product to be tested to ensure that it is suitable for the intended purpose. Only the most recent version of the document is valid. We reserve the right to make changes to reflect advances in technology or improvements to our products.

### Appendix

System drawing

Rev.: 01 February 2022

## Wecryl Surface Protection System OS 8 high-build system

### Substrate

1 e.g. concrete, mechanically pre-treated

### Primer layer

2 Wecryl 176

### Waterproofing layer

#### Waterproofing of details

3 Wecryl R 230 /-thix

4 WeVlies

5 Wecryl R 230 /-thix

### Protective and wearing layer

6 Wecryl 488

7 Wecryl 418

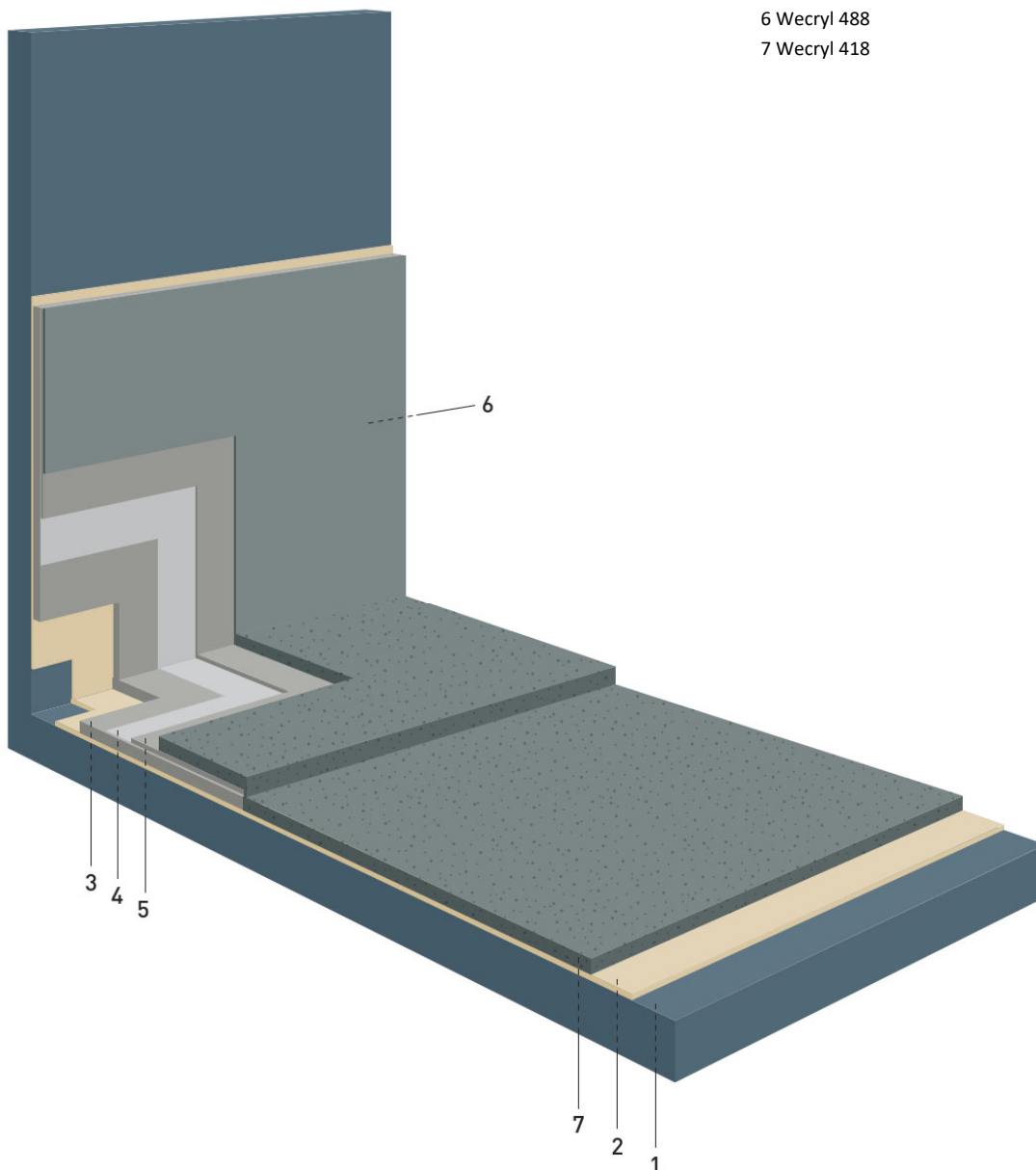

Rev.: 01 February 2022

westwood\_de-de\_vr\_wecryl-oberflächensch-sys\_os8\_dickschicht